

# The New Standard in Mortar Application.



The MORTAR SPRAYING LANCE for High-Performance  
Thermal and Acoustic Insulation.



# Your Reputation is Built from the Top Down.

Every roof is the building's first line of defense. For construction and waterproofing professionals, the quality of the application isn't just about performance—it's about client trust, long-term durability, and the integrity of the entire structure.

Mediocre application leads to costly failures, wasted materials, and compromised results.

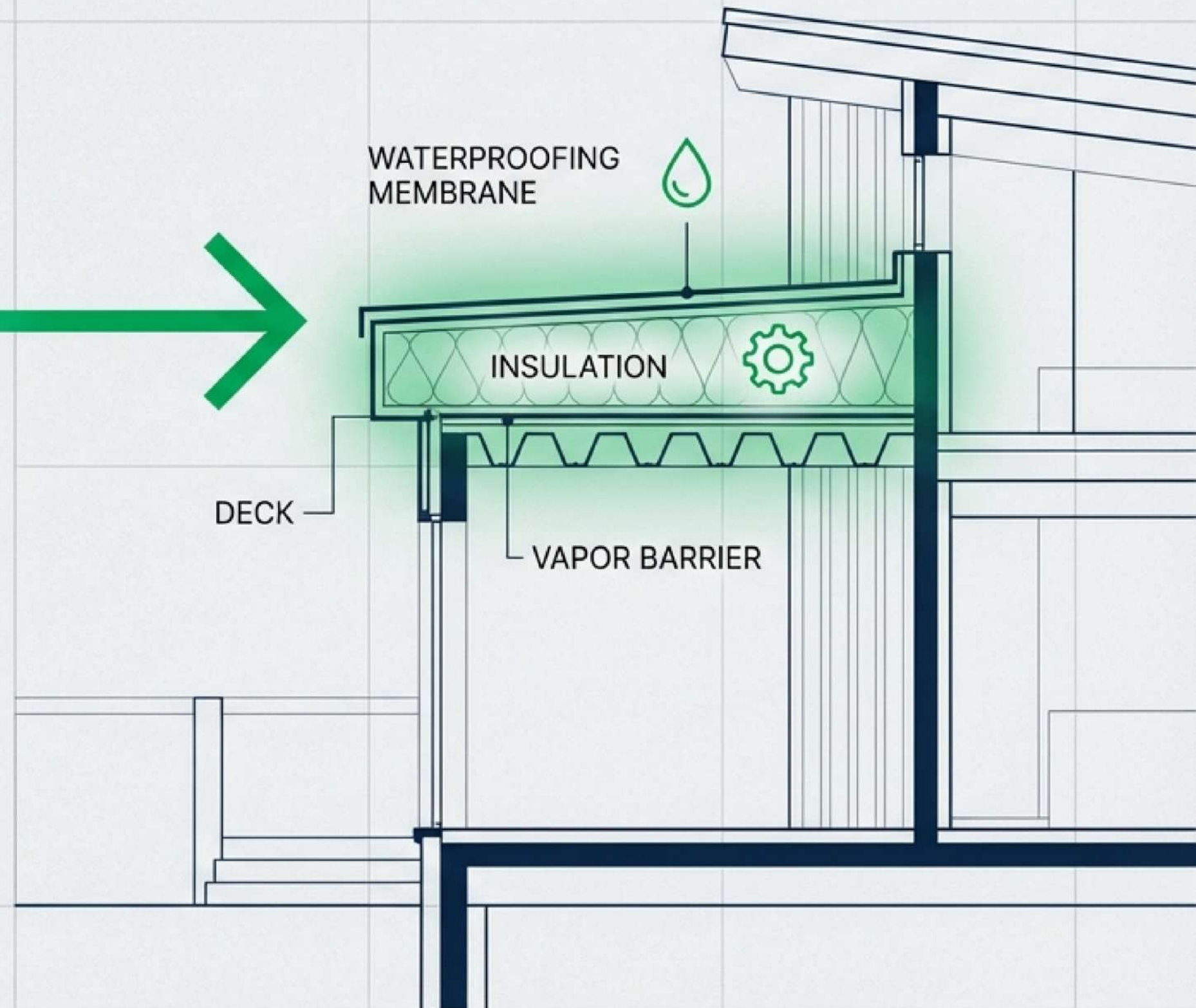



# The Challenge: Applying High-Performance Mortars Demands More Than Standard Tools.



## Inconsistent Coverage

Leads to thermal bridging and weak points in the building envelope.



## Material Waste

Poor flow control results in costly overspray and cleanup.



## Slow Application Speed

Manual or inefficient methods extend project timelines and labor costs.



## Lack of Adaptability

Generic tools can't adjust to the specific viscosity of materials like Suberlev mortars or Natural Cork Spray.



# Engineered for the Expert: The **MORTAR** **SPRAYING LANCE.**

The ideal tool designed specifically for construction and waterproofing professionals applying Suberlev thermal mortars or Sprayed Natural Cork to roofs. It's not just an accessory; it's a high-performance system for achieving superior results.





# The Anatomy of High Performance.

Every component of the Mortar Spraying Lance is engineered to provide a distinct advantage on the job site. We will break down how its design delivers unmatched precision, versatility, efficiency, and durability.

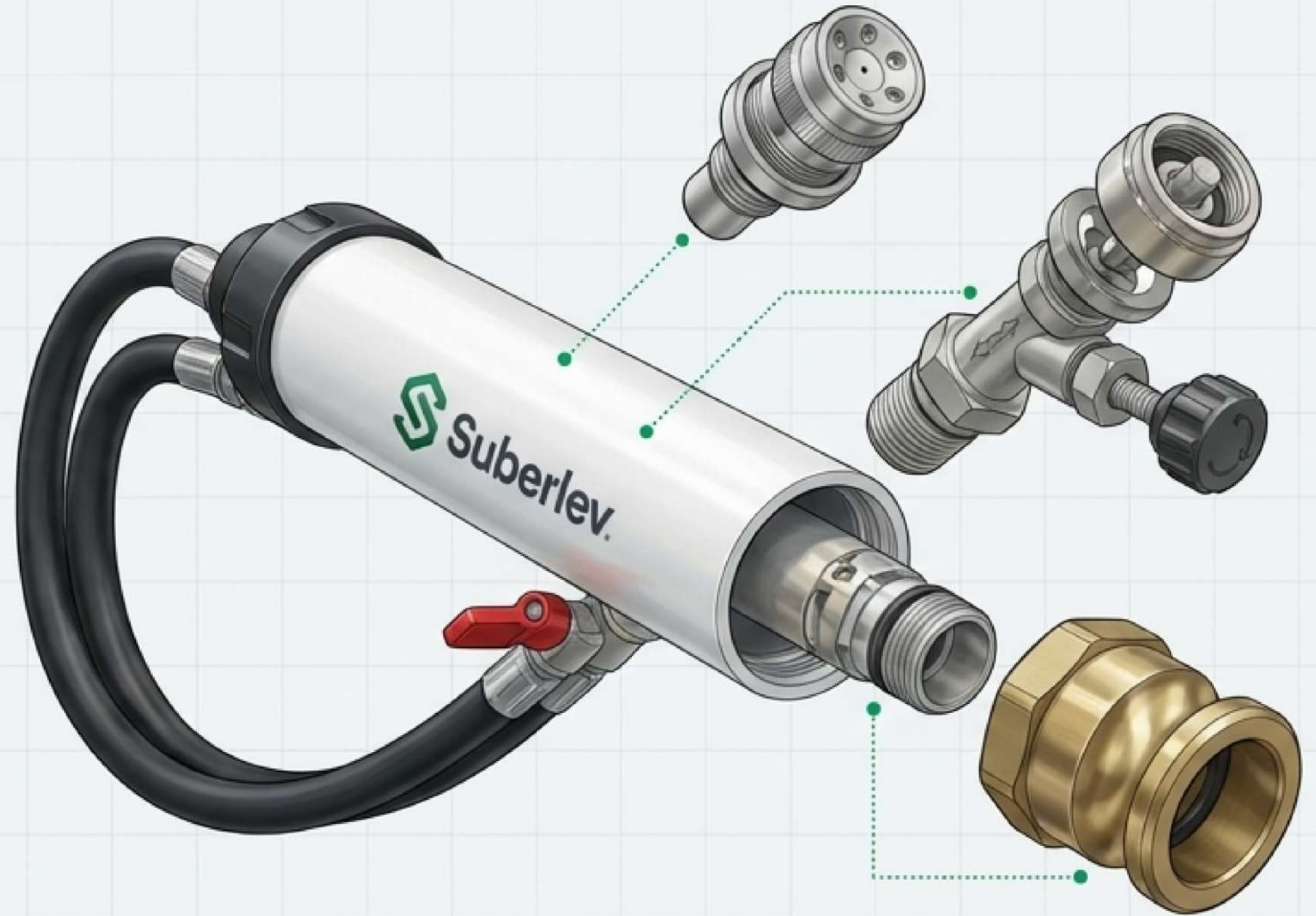





# Total Control for a Flawless Finish.

**Key Feature:** Precise Air and Flow Regulation.

The integrated valve gives you direct control to adjust the material flow according to the specific needs of each project, from wide coverage to detailed work.

**Professional Benefit:** Achieve a precise and perfectly uniform application, resulting in high-quality, aesthetic finishes and optimized material consumption.





# One Tool, Engineered for Every Application.

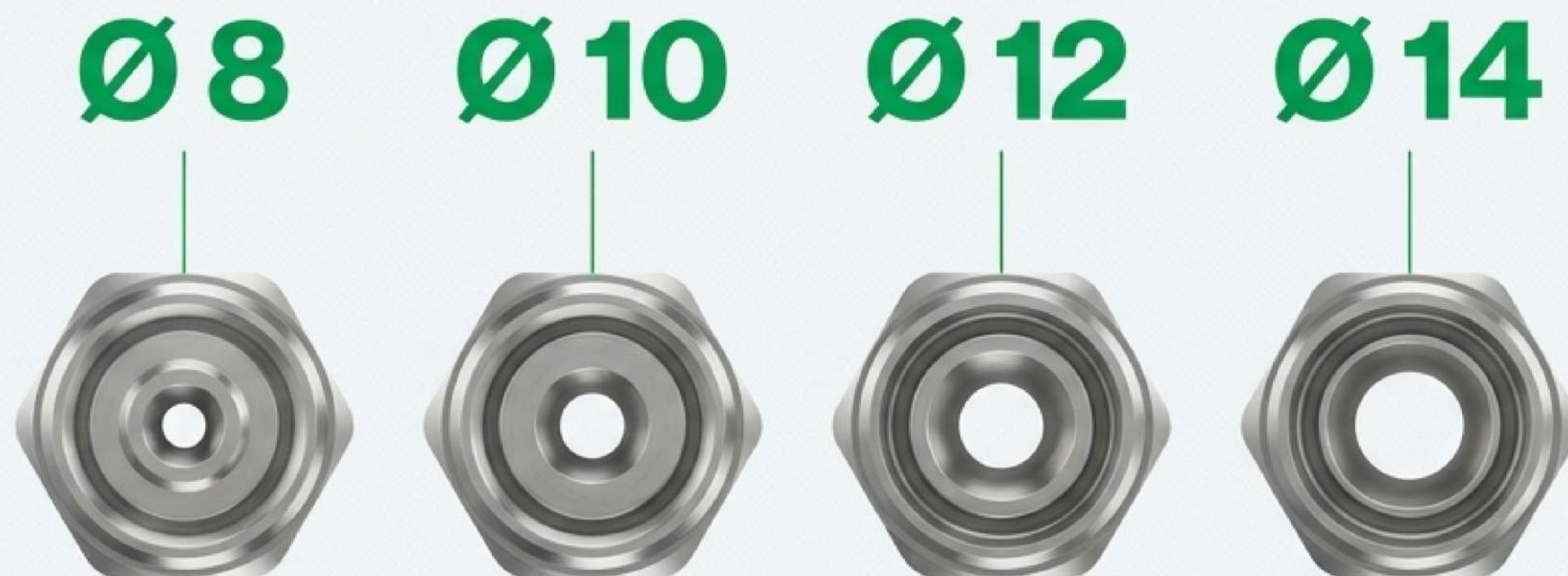

**Key Feature:** Interchangeable Passage Nozzles. Includes a complete set of Ø 8, 10, 12, and 14 passage nozzles to adapt to different material viscosities and application requirements.

**Professional Benefit:** The versatility to deliver the ideal spray pattern and thickness for any roof project, ensuring optimal performance of both Suberlev and Natural Cork Spray mortars.



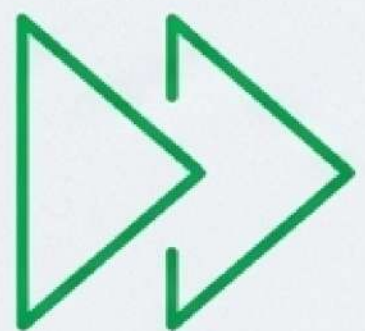

# Accelerate Your Workflow

## Key Feature: High-Performance Design & Camlock Quick Couplings

Designed for fast and efficient work. The Camlock quick couplings ensure an easy, secure, and rapid connection to the spraying machine, minimizing setup and teardown time.

**Professional Benefit:** Optimize your time and resources on site. Complete projects faster, reduce labor hours, and increase your capacity for more work.

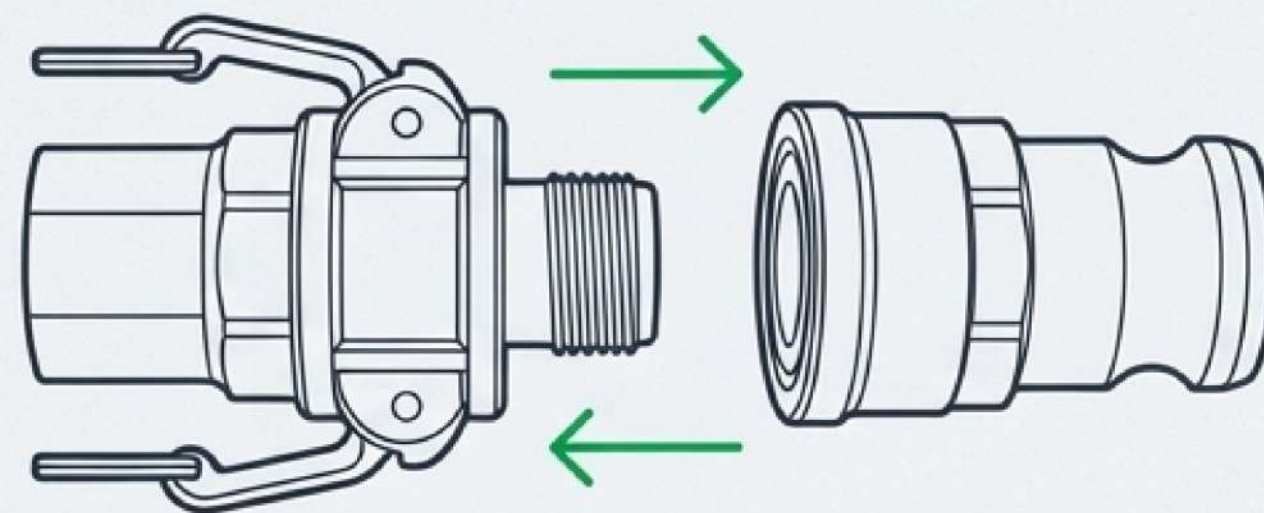

Disconnected

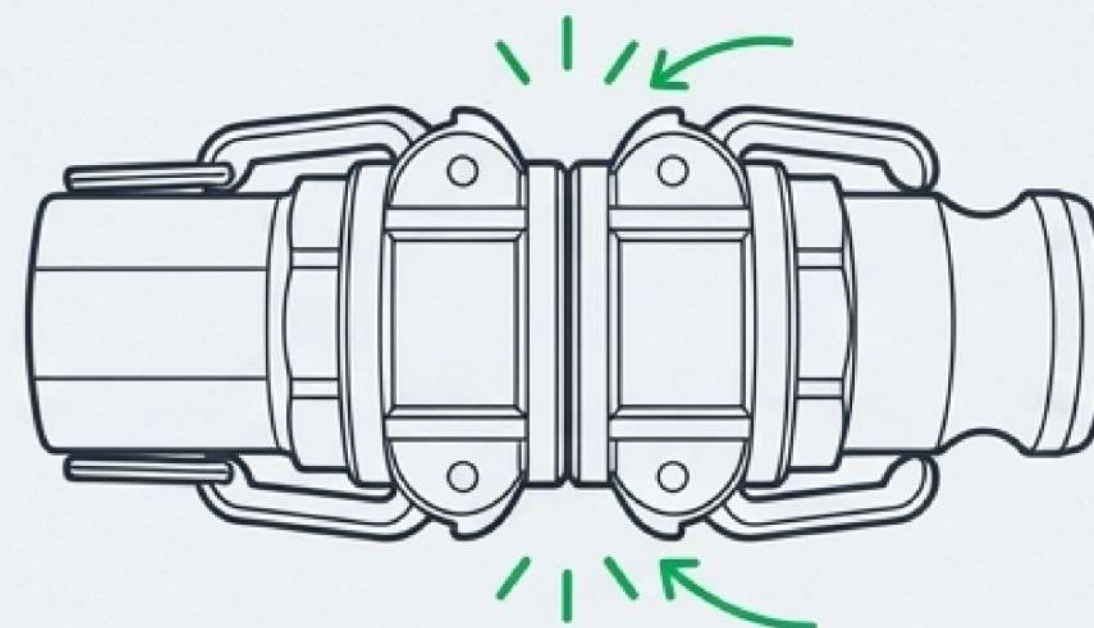

Connected



# Built to Withstand the Professional Job Site.



**Key Feature:** Robustness and Durability. The lance is constructed with high-quality materials selected to endure the rigors of daily professional use, resisting abrasion and wear.

**Professional Benefit:** A reliable and efficient tool with a long service life, ensuring a sound investment that you can depend on project after project.



# From Engineering Feature to Professional Advantage.

Characteristic	Your On-Site Advantage
Precise & Uniform Application	Superior, aesthetic finishes.
Air & Flow Regulation	Optimized material consumption; less waste.
Interchangeable Nozzles (Ø 8–14)	Versatility for different mortars and jobs.
Camlock Quick Couplings	Faster setup; reduced downtime.
High-Performance Design	Accelerated project completion.
Robust, High-Quality Materials	Long service life and reliable ROI.



# The Foundation of a Perfect Finish

## Traditional Methods



## Lance Application

Uniform

Efficient

Precise



# Deliver a Triple-Shield of Protection

Using the Mortar Spraying Lance allows you to deliver the full potential of high-performance mortars.



## Superior Thermal Insulation

Reduce energy consumption and improve interior comfort for the building's occupants.



## Effective Sound Insulation

Drastically reduce the transmission of airborne and impact noise, creating quieter, more comfortable environments.



## Durable Waterproofing

Protect roofs from moisture, leaks, and water damage, ensuring the longevity and integrity of the building.



# Elevate Your Projects. Grow Your Business.

The Mortar Spraying Lance is more than a tool—it's an investment in your professional standard.



## Enhance Your Reputation

Consistently deliver flawless, high-quality finishes that build client trust.



## Increase Profitability

Optimize time and materials on every job to improve your bottom line.



## Guarantee Longevity

Provide durable, long-lasting thermal, acoustic, and waterproofing protection that your clients can rely on.



# **Experience the Precision, Efficiency, and Versatility for Yourself.**



Buy the MORTAR SPRAYING LANCE now to transform your application of Suberlev thermal mortars and Sprayed Natural Cork on roofs.



# Help Us Help You

## Innovation in Protection.



The information provided is based on extensive practical experience and laboratory testing.  
We recommend practical tests to ensure compatibility for each specific application.



Falconstema



2bis, Rue de Violettes,  
98000 Monaco



[info@falconstema.mc](mailto:info@falconstema.mc)



+377 99 90 56 35